

## DISASSEMBLY

### 1. REMOVE SHIFT FORK NO.2 AND NO.3

Remove the 2 bolts and shift fork No.2 and No.3.

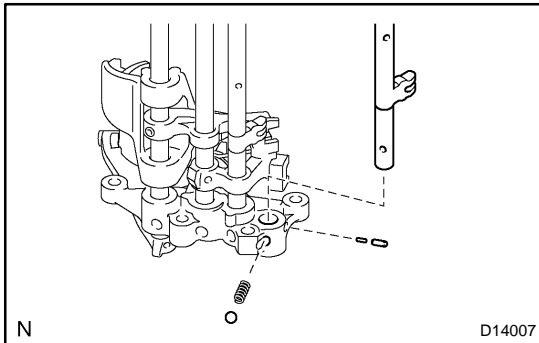

### 2. REMOVE SHIFT FORK SHAFT NO.3

Remove the shift fork shaft No.3, ball, spring, interlock pin No.2 and interlock pin No.3.

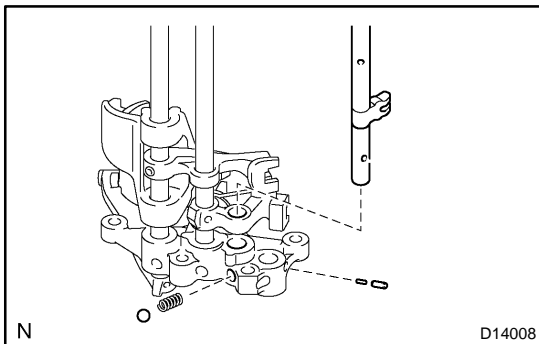

### 3. REMOVE SHIFT FORK SHAFT NO.2

Remove the shift fork shaft No.2, ball, spring, interlock pin No.2 and interlock pin No.3.

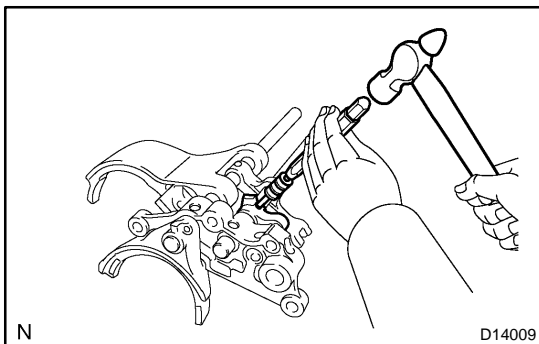

### 4. REMOVE SHIFT HEAD NO.1

(a) Using a pin punch (5 mm (0.20 in.)) and hammer, tap out the slotted pin.

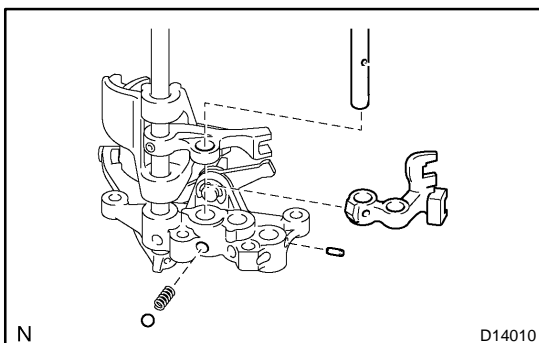

(b) Remove the shift fork shaft No.1, ball, spring, shift head No.1 and interlock pin No.1.

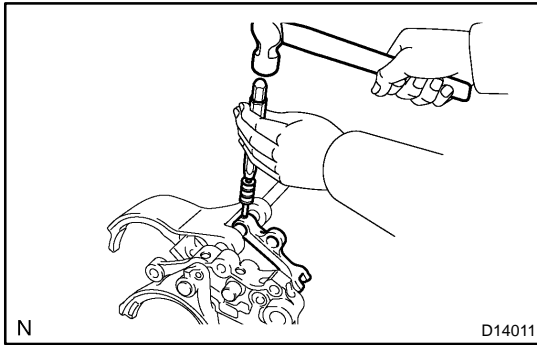

- 5. REMOVE SHIFT HEAD NO.2 AND SHIFT FORK NO.1**
- (a) Using a pin punch (5 mm (0.20 in.)) and hammer, tap out the slotted pin.

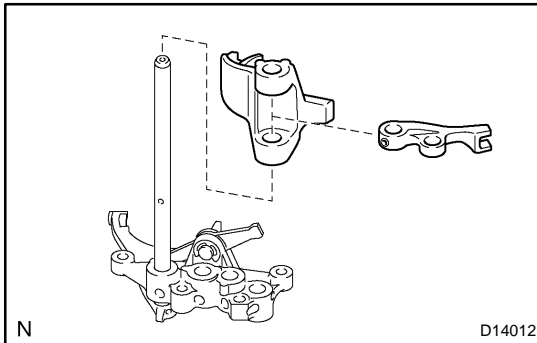

- (b) Remove the shift head No.2 and shift fork No.1.

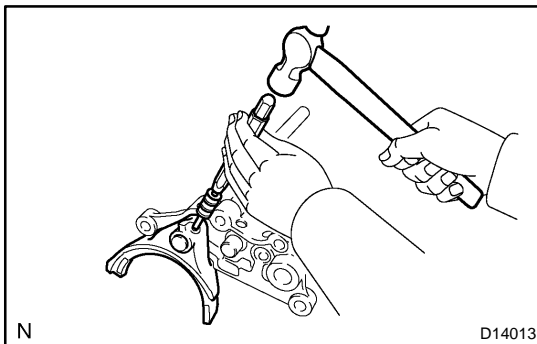

- 6. REMOVE SHIFT FORK NO.4**
- (a) Using a pin punch (5 mm (0.20 in.)) and hammer, tap out the slotted pin.
- (b) Remove the shift fork No.4.

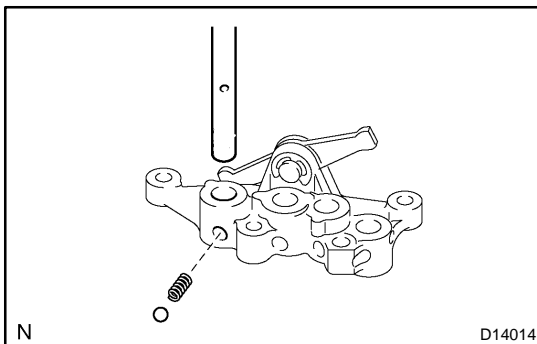

- 7. REMOVE SHIFT FORK SHAFT NO.4**
- Remove the shift fork shaft No.4, ball and spring.

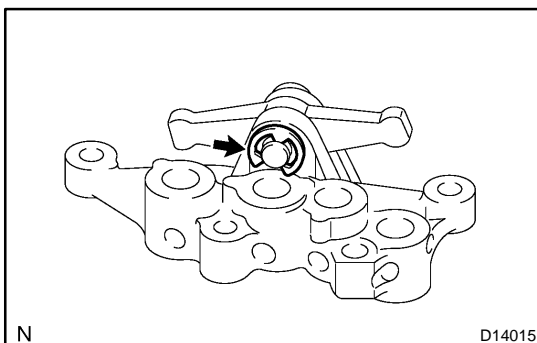

- 8. REMOVE SHIFT ARM**
- (a) Using a screwdriver, remove the E-ring.

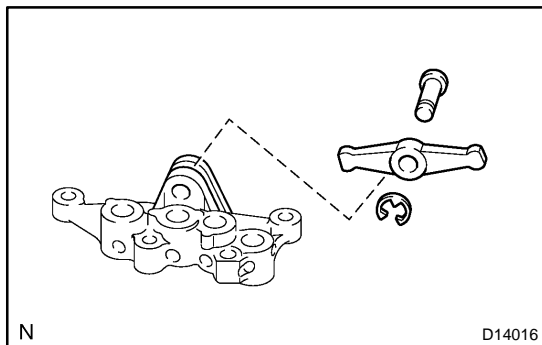

- (b) Remove the shift arm pivot and shift arm.

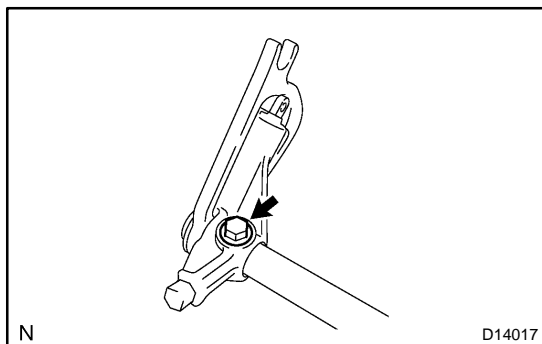

## 9. REMOVE SHIFT & SELECT LEVER

- (a) Remove the bolt from the shift & select lever.  
(b) Using a screwdriver, remove the E-ring.

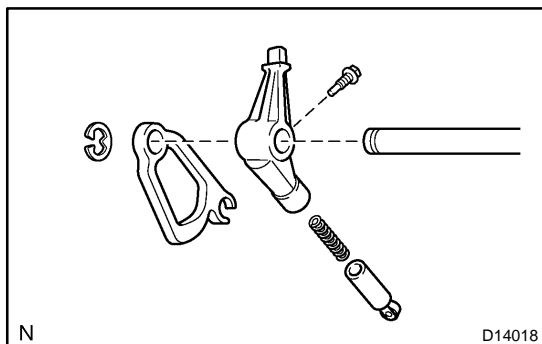

- (c) Remove the shift & select lever cam, shift & select lever, lock ball pin and spring from the shift & select shaft.